

AIR CONDITIONING SYSTEM

IN-DASH

22105 TXV OPTIONAL EVAPORATOR



EXTREME CLIMATE EVAPORATORS

The In-Dash evaporator optional addition for IC school bus model is the smart choice to the aftermarket system. If tied to Spheros 126,000 dual inwall system, the capacity would be approximately 144,000 BTU/hr.

WWW.SPHEROS.COM/US

SPHEROS

22105 TXV IN-DASH EVAPORATOR

HIGHLIGHTS



Design

- Designed to be a dash mounted
- High performance motors with extended brush life
- Stand alone or can be tied to rear air conditional system.



Features

- TXV with an enhanced drier
- 3 speed fans
- Optional w/heat 30k BTU/h heat capacity
- Optional heat coil: 11128003A
- Plenum available if application applies

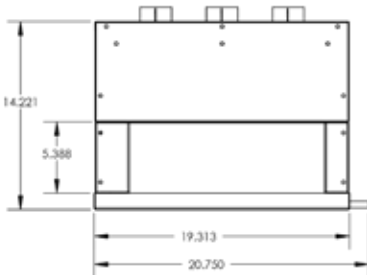
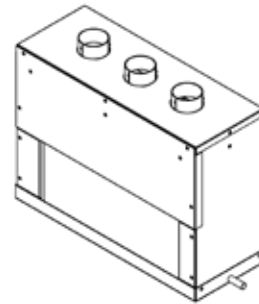
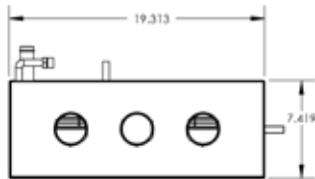

TECHNICAL DATA

Model	Up to Cooling Capacity	Power Consumption	Nominal Voltage	Dimensions L x W x H	Weight
22105	18,000 BTU/h	10 Amps	12V	21 x 7.5 x 15.5 in	30 lbs.